

Detailed T110 Programing

Step 1

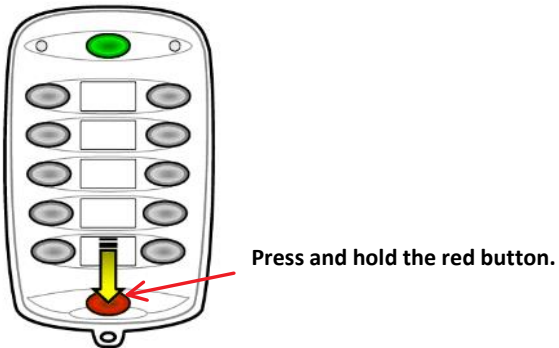

Step 2

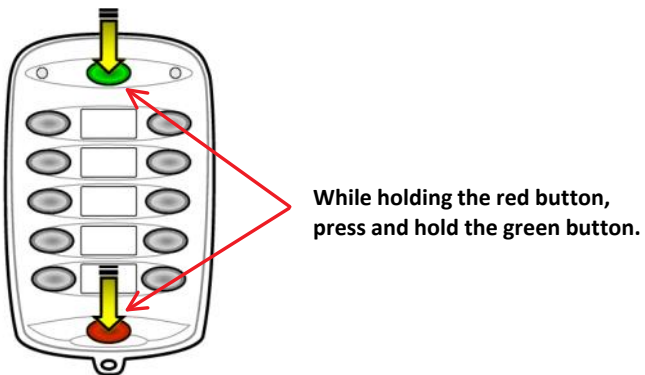

Step 3

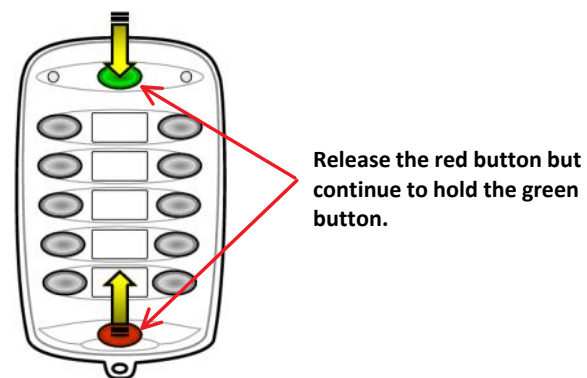

Step 4

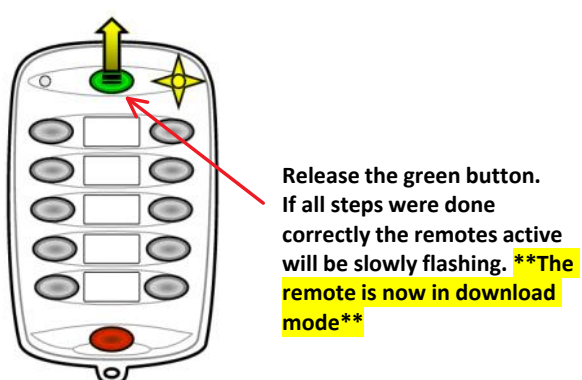

Step 5 (Option 1) *USE THIS FOR R260 Modules*

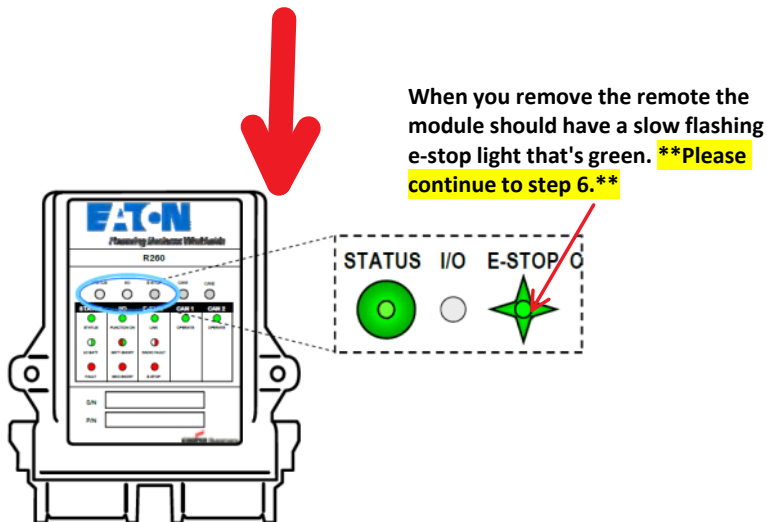
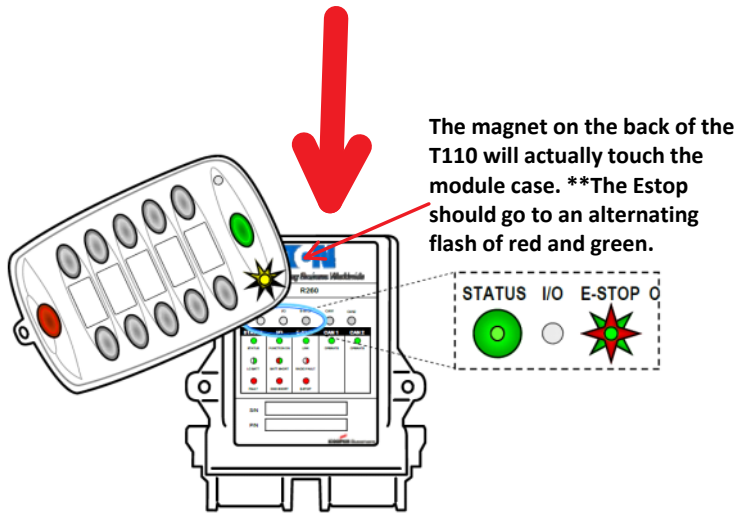
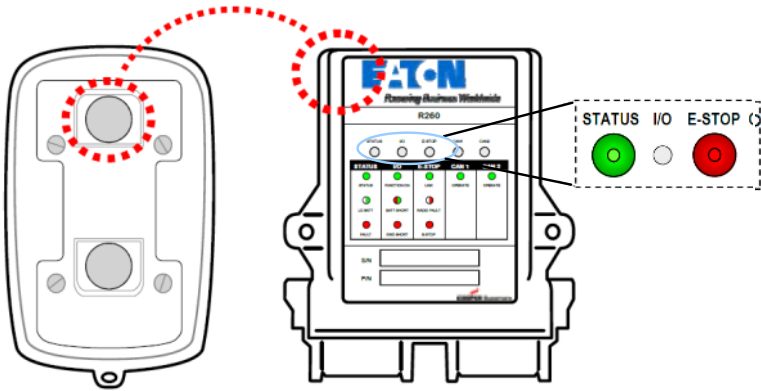

Step 5 (Option 2) **Use this for R160 & R170 Modules**

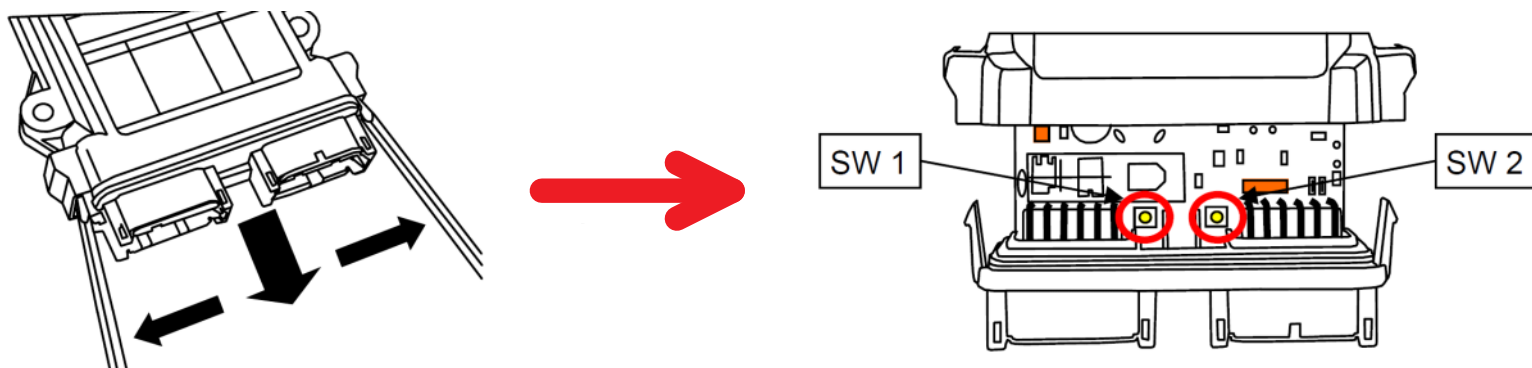

Press and hold SW 1 until the Estop light goes from red to alternating flash of red and green.

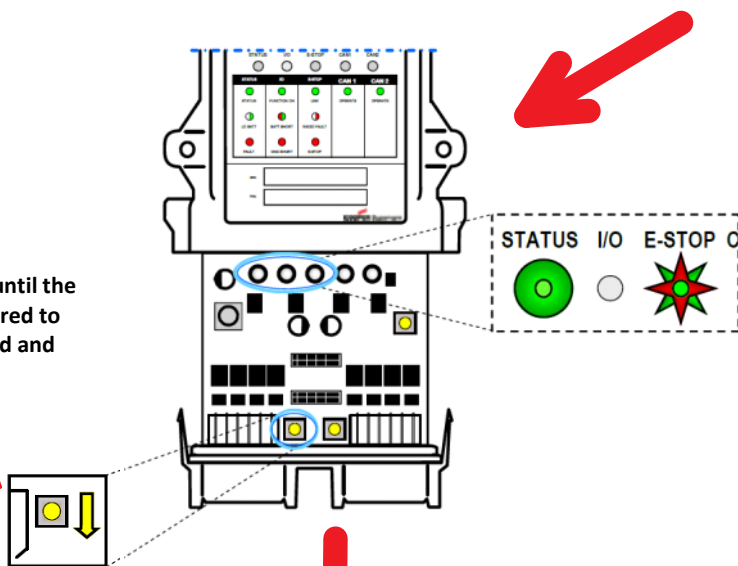

Release SW 1 and the Estop light will go to a slow green flash.
****Please continue to step 6.****

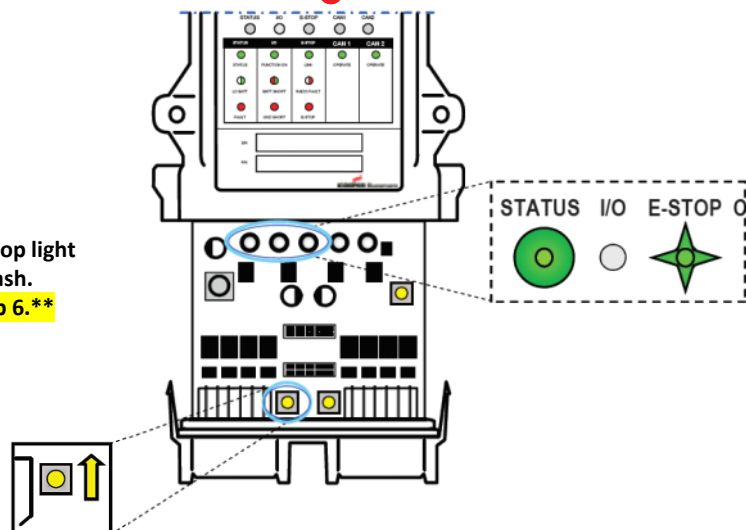

Step 6

Press the green button to download the ID code. **** The remote needs to still be in download mode (please see step 4). ****

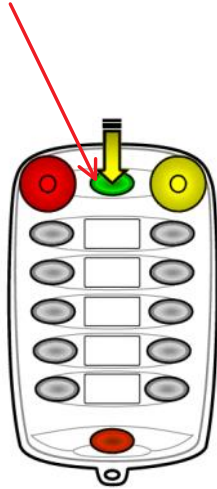

When the remote ID code is completely downloaded the remote will turn off and the module's Estop light will go from flashing green to solid red.

